



OUTBACK MOTORTEK

KTM 390 Adventure R

ASSEMBLY GUIDE | REAR COMBO

Tools Required

- Ratchet + Extension
- 6mm Allen Socket
- 13mm Wrench/Spanner
- Blue Loctite (recommended)

Number	QTY	Specifications	Torque (NM)
<u>1</u>	4	OEM Hardware	*
<u>2</u>	2	M8 x 60mm Tapered Allen Head	*
<u>3</u>	2	M8 x 60mm Allen Head	*
<u>4</u>	4	M8 x 20mm Tapered Allen Head	23
<u>5</u>	6	M8 Washer	-
<u>6</u>	4	M8 Nyloc Nut	-
<u>7</u>	2	37.5mm Spacer	-
<u>8</u>	2	25mm Spacer	-

* PLEASE REFER TO THE OWNER'S (OR SERVICE) MANUAL FOR **OEM** TORQUE SPECIFICATIONS.*

STEP 1:

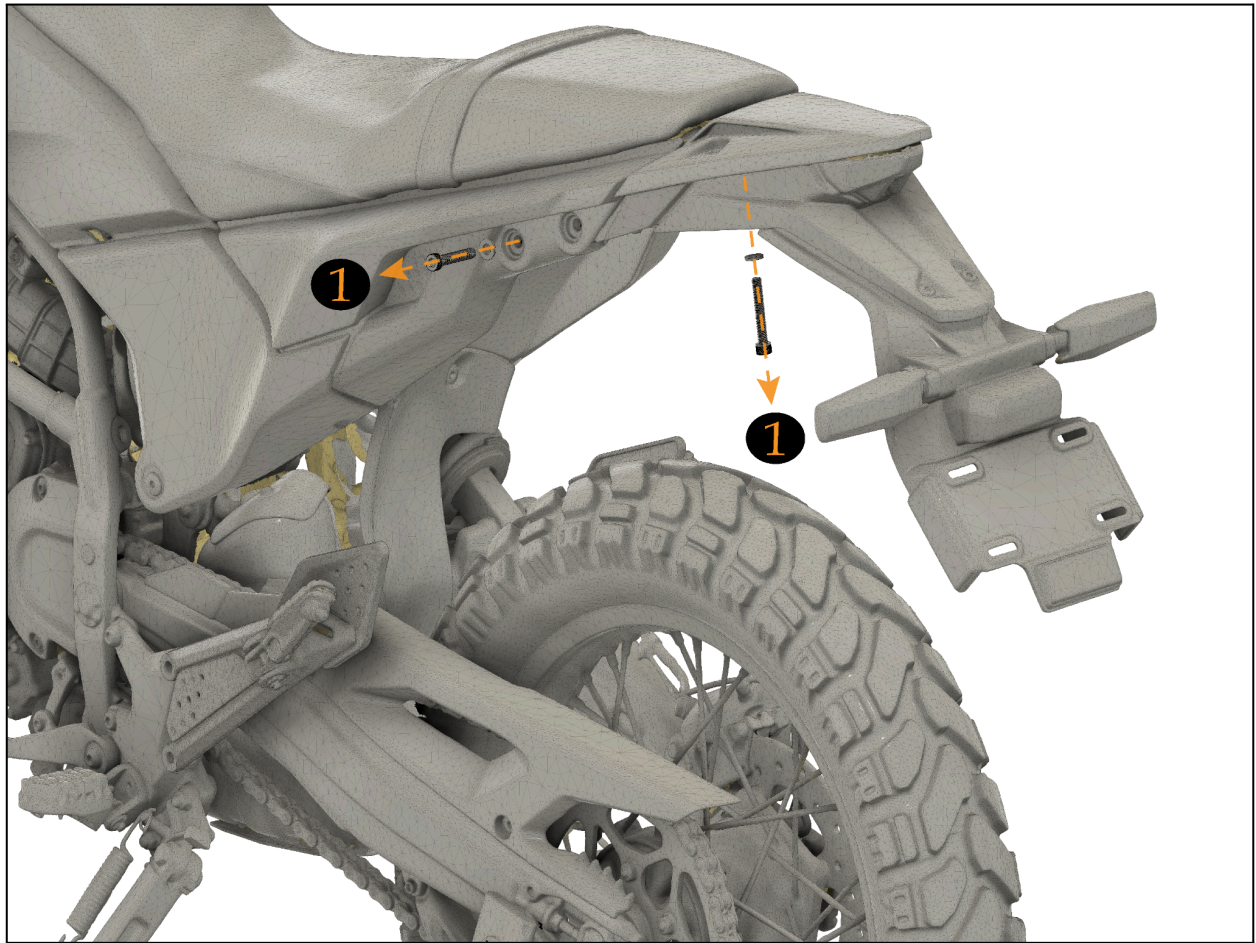

STEP 2:

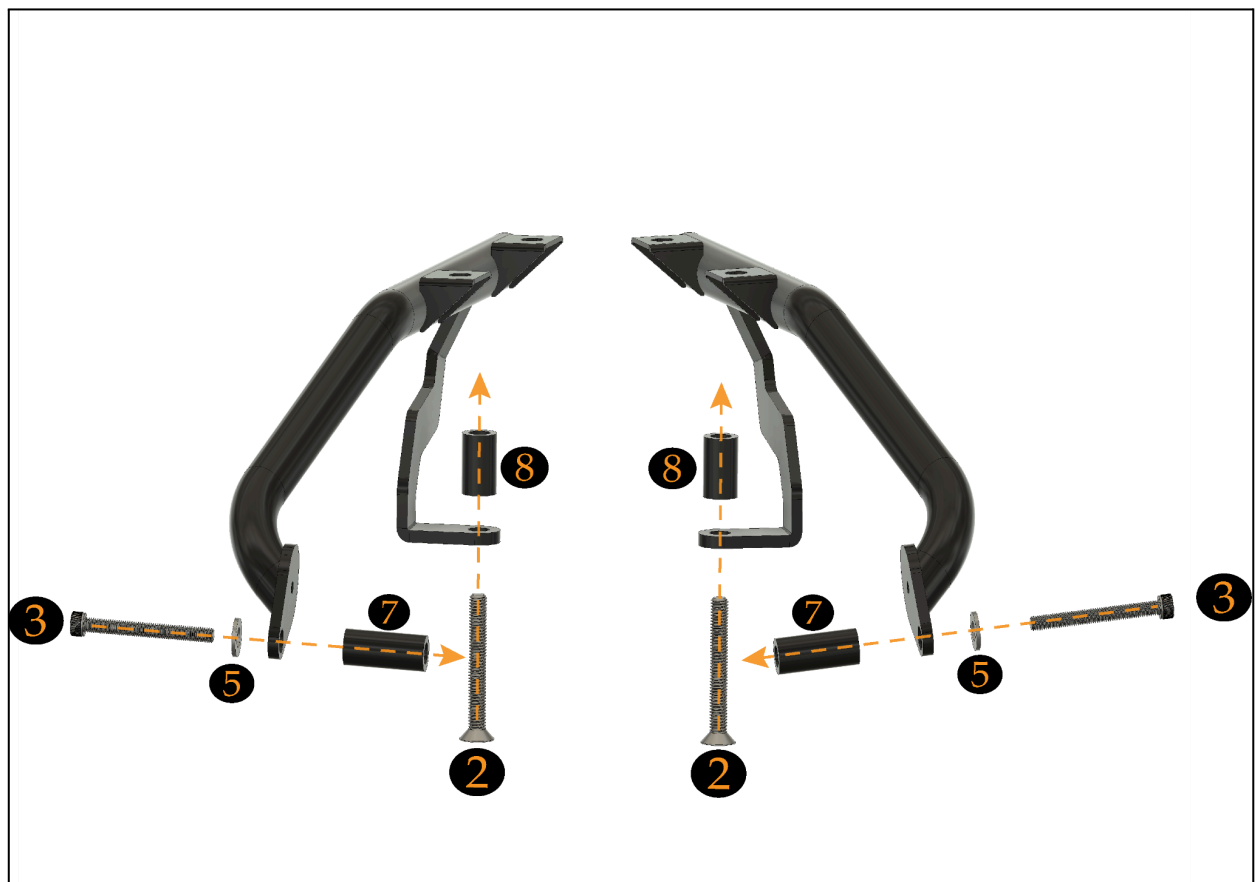

STEP 3 :



*** Torque Disclaimer ***

Torque specs provided by Outback Motortek are for guidance only and may reference OEM data. Incorrect torque application from miscalibrated or improperly stored torque wrenches (which can drift by up to 20% within 12 months) may cause broken studs or mounting failures. Always return torque wrenches to 0 ft-lbs when storing, and use blue Loctite (medium strength) on all fasteners to help prevent loosening. Outback Motortek is not responsible for damage or failures caused by mis-torquing or improper installation.